

# DECAL INSTALLATION GUIDELINES

## Tools Needed:

- Measuring tape or ruler
- 3/4 inch masking tape
- Soap solution in (use one drop of soap per quart of water)
- Spray bottle
- Squeegee - included inside the box with with your decal purchase  
be sure to check your box before discarding!  
(NOTE: emblem decals do not come with a squeegee)



## Please read the following guidelines and intructions carefully BEFORE applying your decal:

- Please do not apply decals dry or in the direct sun light
- Vehicle surface should be cool
- Maple Valley Signs is not responsible for human errors during installation.

## INSTRUCTIONS

1. Clean area thoroughly, with Dawn or any other dishwasher soap, where decal will be applied. This will remove all dirt and wax on the decal application area
2. Position decal and use masking tape on both ends, making sure that the decal is level or evenly spaced on the borders. Measure if necessary
3. Tear or cut tape on one end of the decal. Be sure to leave the tape that you tear in place to use as a registration mark for positioning the decal
4. Lift the decal on the end with the broken tape and remove the paper backing
5. Wet the sticky side of the decal with the soap solution and the area to be applied on the vehicle.
6. Lay the decal on the surface, lining the cut tape on the decal with the part of the tape still on the surface
7. Starting from the end of the decal that is taped down, squeegee the decal until all the liquid is removed. Repeat the process with harder strokes with the squeegee.
8. Once the decal has had time, 20-30 minutes, to dry carefully pull the transfer tape from the decal.
9. Natural sun light will remove the air bubbles trapped in the decal. If bubbles persist poke the bubbles with an Exacto blade and squeegee the material again with light strokes be careful that you don't scratch the vinyl.
10. **Admire you work and tell your friends about Maple Valley Signs...Always A Good Sign!**

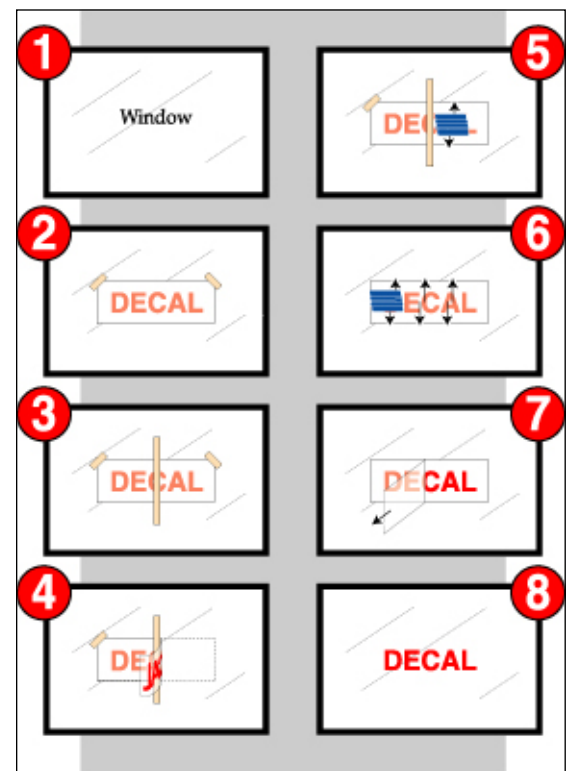

MAPLE VALLEY SIGNS - 425.413.1430 • Email - [info@maplevalleysigns.com](mailto:info@maplevalleysigns.com)

23220 Maple Valley Black Diamond Rd., Bldg. 3 Suite F, Maple Valley, WA 98038